

Type: M22-CKC10
Article No.: 216386



Ordering information

Contacts M = Make

1 M

Contact sequence



Contact travel diagram, stroke in connection with front element

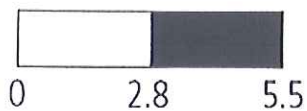

Configuration

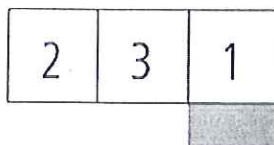

Notes concerning the table header

Contacts

M = make, B = break

 = positive opening safety function according to IEC/EN 60947-5-1

Notes concerning the table header

14
15

x = sequence number on fixing adapter

y = function number on contact element

Assignment: Assignment of the fixing adapter with sequence numbers according to EN 50013

General

Standards			IEC/EN 60947 VDE 0660
Lifespan, mechanical	Operations	$\times 10^6$	> 5
Operating frequency	Operations/h		f 3600
Operating force		n	5
Operating torque (screw terminals)		Nm	0,8
Degree of protection, IEC/EN 60529			IP20
Climatic proofing			Damp heat, constant, to IEC 60068-2-78 Damp heat, cyclic, to IEC 60068-2-30
Ambient temperature			
Open		°C	-25/70
Mounting position			As required
Mechanical shock resistance to IEC 60068-2-27 Shock duration 11 ms, half-sinusoidal		g	> 30
Terminal capacities			
Solid		mm ²	0.75 – 2.5
Stranded		mm ²	0.5 – 2.5

Contacts

Rated impulse withstand voltage	U_{imp}	V AC	6000
Rated insulation voltage	U_i	V	500
Overvoltage category/pollution degree			IIID3
Control circuit reliability			
at 24 V DC/5 mA	H_F	Fault probability	$< 10^{-7}$, < 1 fault in 10^7 operations
at 5 V DC/1 mA	H_F	Fault probability	$< 5 \times 10^{-6}$, < 1 fault in 5×10^6 operations
Max. short-circuit protective device			
Fuseless		Type	PKZM0-10/FAZ-B6/1
Fuse	gG/gL	A	10

Switching capacity

Rated operational current

AC-15

115 V	I_o	A	6
230 V	I_o	A	6
400 V	I_o	A	4
500 V	I_o	A	2

DV-13

24 V	I_o	A	3
42 V	I_o	A	1,7

60 V	I_e	A	1,2
110 V	I_e	A	0,8
220 V	I_e	A	0,3

Lifespan, electrical

AC-15

230 V/0.5 A	Operations	$\times 10^6$	1,6
-------------	------------	---------------	-----

230 V/1.0 A	Operations	$\times 10^6$	1
-------------	------------	---------------	---

230 V/3.0 A	Operations	$\times 10^6$	0,7
-------------	------------	---------------	-----

DV-13

12 V/2.8 A	Operations	$\times 10^6$	1,2
------------	------------	---------------	-----

Dimensions

Dimensions

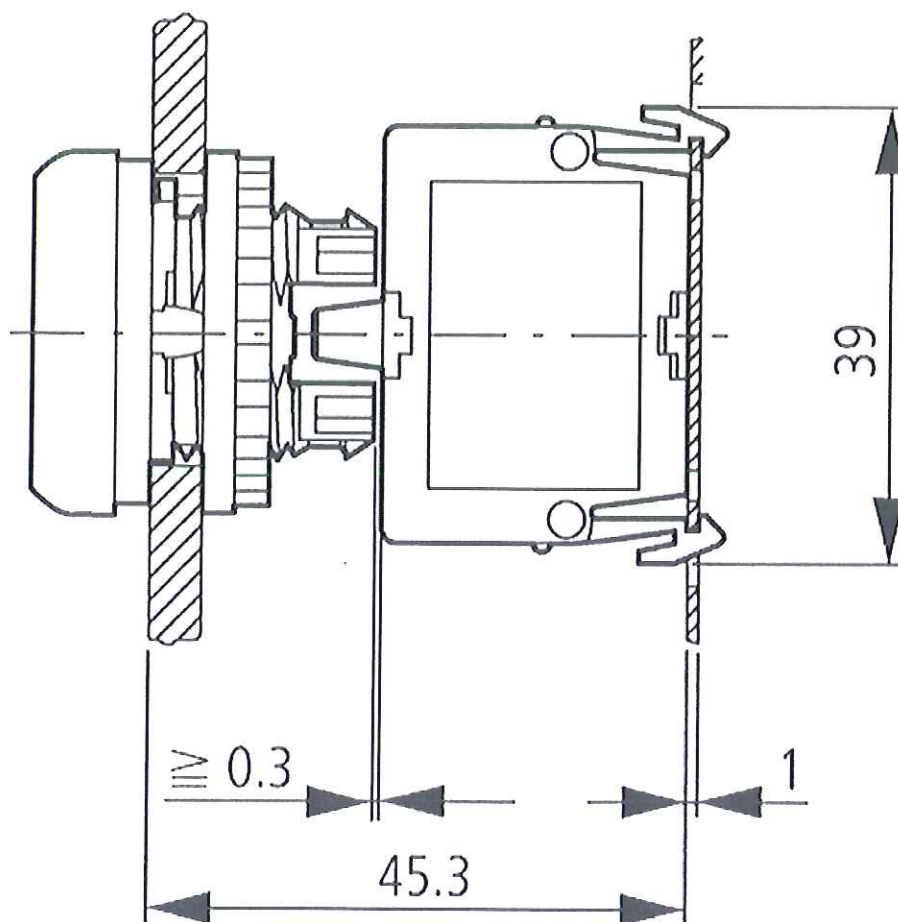

Moeller GmbH, Hein-Moeller-Str. 7-11, D-53115 Bonn
 E-Mail: catalog@moeller.net, Internet: www.moeller.net, <http://catalog.moeller.net>
 Copyright 2005 by Moeller GmbH. Subject to modifications. HPL-C2005GB-INT V3.0